



## Lifting and workshop technology

Scissor-type lifting tables  
Pallet trucks  
Pallet stackers  
Handcarts  
Transport rollers and chassis  
Trolley jacks  
Body straightening kits  
Lifting gear  
Load handling equipment  
Chain hoists  
Rope winches  
Machine jacks  
Workshop presses



## UNICRAFT Lifting and workshop technology for professional users in trades and industry



*Sales and service Germany at Hallstadt / Bamberg*

### Dear customers,

Our aim is to make your work easier.

When you purchase UNICRAFT products, you can look forward to lifting and workshop technology that meets your requirements in terms of ease of use, equipment level, quality and engineering. On top of this the complete range of UNICRAFT products impresses with its extraordinary price-performance-ratio.

Thanks to our network of specialist retailers, will always find a local partner happy to offer you advice, hands-on support and after-sales service.

And, of course, our team of experts is there to help you at any time.

**Kilian Stürmer**  
General Manager

**Robert Stürmer**  
Sales Manager



The new logistics center with 16,000 m<sup>2</sup> storage area (from March 2014).



## Lifting platforms

### Scissor-type lifting tables

FHT 500	.4
SHT Series	.5

## Pallet trucks

### Pallet trucks

PHW Series	.6
PHW W Series	<b>New</b> .7

### Scissor pallet trucks

PHH 1001	.8
PHH 1002 E	9

### Pallet stackers

GHHW 1000	10
-----------	----

## Transportation aids

### Universal chassis

UF 230	11
--------	----

### Lifting rollers

HR 1000	11
---------	----

### Corner transport rollers

ETR 4/150	12
-----------	----

### Crowbars

HS Series	12
-----------	----

### Transportation rollers

TR Series	12
VTR Series	12

### Transport chassis

TF Series	13
-----------	----

### Transport roller kit

TR 20	13
-------	----

## Vehicle jacks

### Hydraulic vehicle jacks

HSWH Series	14
HSWH-Pro Series	14

### Support stands

UB Series	14
UBK Series	14

### Floor jacks

RWH Series	15
RWHA Series	15

### Special floor jacks

SRWH Series	16
SRWH-Pro Series	17

### Special floor jacks, pneumatic-hydraulic

WWH PH Series	18
---------------	----

### Carmovers

PV 680	18
--------	----

## Assembly aids

### Vehicle ramps

KR 2000	19
---------	----

### Motorcycle lifting platforms

MH 680 / MHB 400	19
------------------	----

### Workshop crane

WK 2000	20
---------	----

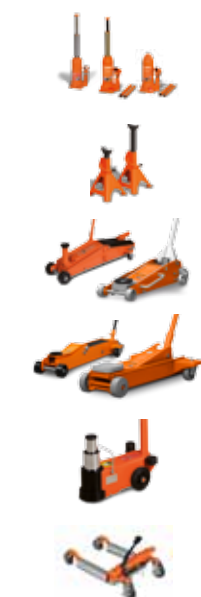

### Engine mounting gantries

MMB 500	20
---------	----

### Engine positioners

MP 680	20
--------	----

### Gearbox hoists

GH Series	20
-----------	----

### Engine assembly trestles

MMB 450	21
---------	----

### Skateboards

MRB 40 KS / KRL 1	21
-------------------	----

### Assembly stool

MH 1	21
------	----

## Fans

### Mobile fans

MV Series	22
-----------	----

## Lifting gear

### Permanent load lifting magnets

PLM Series	<b>New</b> 22
------------	---------------

### Chain hoists

K series	23
----------	----

### Universal cable winches

USZ series	23
------------	----

### Lever hoists

HZ series	23
-----------	----

### Wall swivel arm

WSA Series	24
------------	----

### Electrical cable winch

ESW 900	23
---------	----

### Mini electrical cable winches

MES series	24
------------	----

### Electric chain hoists

EKZT Series	25
EKZF Series	25

### Crane scales

KW Series	26
-----------	----

### Steel winches

SW Series	26
-----------	----

### Machine jacks

MH Series	27
HMH Series	27

## Workshop presses

### Workshop presses

WPP E Series	28
--------------	----

## Sandblasting cabinets

### Sandblasting cabinets

SSK Series	30
------------	----

## Miscellaneous

### Body straightening kit

HKRS 1000	31
-----------	----

### Vices and anvils

Vice Series	31
Anvil Series	31



## FHT 500 – Mobile scissor-type lifting table with hydraulic lifting device and load-bearing capacity of 0.5 t

- Robust steel design
- For flexible and comfortable working
- With an easy-to-operate foot pedal for raising the table hydraulically to the desired height
- Manually operable table lowering
- Robust rollers with safety wheel guard and brakes on the two steering rollers for greater safety during loading and unloading
- The relief valve protects the operator and the pump



• Easy-to-operate hydraulic foot pedal



• Hydraulic lifting and lowering device



• Robust rollers with safety wheel guard and brakes on the two steering rollers for greater safety during loading and unloading



• Easy and conveniently operable table lowering

<b>Model</b>	<b>FHT 500</b>
Article no.	615 0500
<b>Technical data</b>	
Load-bearing capacity	500 kg
Table dimensions	855 x 500 x 50 mm
Max. lifting height	900 mm
Min. table height	340 mm
Grip height	805 mm
Max. pedal pushes over height	55
Roller Ø	127 mm
Weight	87 kg

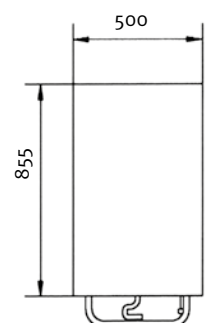
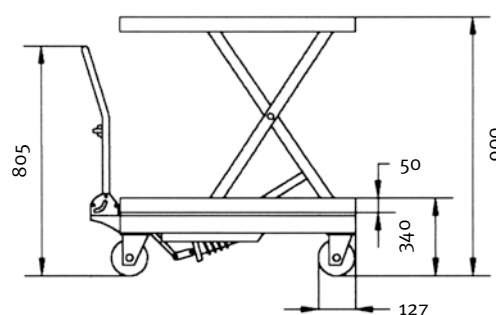



## SHT 1000, SHT 2000 – Compact, hydraulic scissor-type tables

- For ergonomic working at an optimum working height
- With closed platform
- Separate control unit with 3 metre cable, control buttons and emergency stop switch
- Infinitely variable lifting and lowering
- Stable, powder-coated steel design
- Guaranteed stability
- Circumferential safety rails
- Fulfils the safety criteria of EN 1570
- High-pressure cylinder with dual-safety function

Model Article no.:	SHT 1000 615 4100	SHT 2000 615 4200
<b>Technical data</b>		
Load-bearing capacity	1 t	2 t
Table dimensions	1300 x 800 mm	1300 x 800 mm
Lifting time	25 sec.	40 sec.
Lifting speed loaded	40 mm/sec.	22 mm/sec.
Output	0.75 kW	0.75 kW
Lifting height min./max.	190 / 1010 mm	190 / 1010 mm
Weight	220 kg	280 kg



## SHT 1001 G / SHT 1001 U – Compact-height lifting tables

### SHT 1001 U model with U-shaped platform

- For ergonomic working at an optimum working height
- With closed platform
- SHT 1001 G including loading ramp - for easy moving in and out with pallet truck
- Separate control unit with 3 metre cable, control buttons and emergency stop switch
- Infinitely variable lifting and lowering
- Robust steel structure for optimum stability
- Fulfils the safety criteria of EN 1570
- Chrome-plated piston rods
- SHT 1001 U model with U-shaped platform ensures easy access with pallet lifting truck

Model Article no.:	SHT 1001 G 615 3100	SHT 1001 U 615 3101
<b>Technical data</b>		
Load-bearing capacity	1 t	1 t
External dimensions of the platform	1450 x 1140 mm	1450 x 1140 mm
Internal dimensions of the platform	-	1050 x 585 mm
Lifting time	18 sec.	18 sec.
Lifting speed loaded	42 mm/sec.	42 mm/sec.
Output	0.75 kW	0.75 kW
Lifting height min./max.	80 / 760 mm	80 / 760 mm
Weight	250 kg	235 kg



**SHT 1001 G**

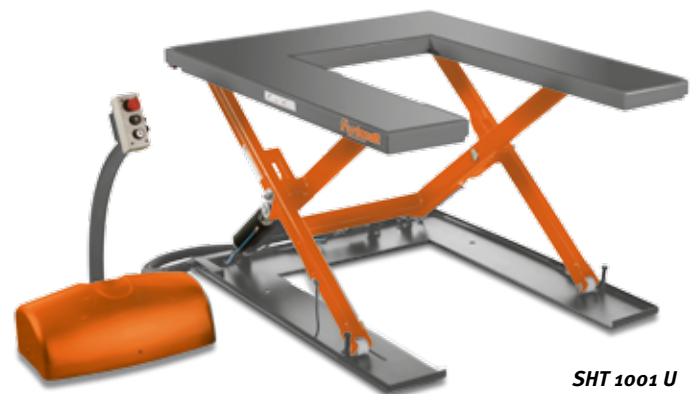

**SHT 1001 U**



- The additional roller in the fork tips facilitates moving into and out of pallets



**PHS 1 - Stopper for pallet lifting truck**  
(Application example/lift truck not included in the scope of delivery)

- Roll-stop for pallet lifting truck, e.g., in commercial vehicles
- Easy to use
- Robust rubber structure with solid plastic handle

**Model** PHS 1  
**Article no.:** 615 0001

**Technical data**

Dimensions (LxWxH)  
(without handle) 295 x 290 x 50 mm  
Weight 1.47 kg

**PHW Series** Professional hand lift trucks in stable, robust quality for demanding daily use – also available with short and long forks

- Robust fully-hydraulic lifting and lowering device
- Smooth-action hydraulic pump with hard chrome-plated piston and pressure relief valve
- Lowering speed infinitely variable thanks to release valve with granular control
- Highly stable, torsion-resistant monocoque design of frame and forks
- Ergonomically shaped drawbar, non-slip with additional plastic coating
- Three functions operable via one-hand lever (lifting, lowering, neutral position)
- Easy to move even heavy loads thanks to super quiet aluminium steering rollers with solid rubber wheel treads and tandem fork rollers made of polyurethane
- Precision ball bearings in all wheels and rollers

- **Model PHW 2505 K** with short forks (800 mm)
- **Model PHW 2005 L** with long forks (1800 mm)

**PHW 2000:**

- Robust fully-hydraulic lifting and lowering device
- Smooth-action hydraulic pump with hard chrome-plated piston
- Gradual, continuous lowering possible with one-handed lever
- Easy to move even heavy loads thanks to smooth-action steering rollers with solid rubber wheel treads and tandem fork rollers
- Smooth running action and low roll resistance thanks to steering and fork rollers with ball bearings



Model	PHW 2000	PHW 2505	PHW 2505 K	PHW 2005 L
Article no.	615 0200	615 0255	615 0256	615 0257
<b>Technical data</b>				
Load-bearing capacity	2 t	2.5 t	2.5 t	2 t
Total width	520 mm	540 mm	540 mm	540 mm
Fork width	150 mm	160 mm	160 mm	160 mm
Fork length	1150 mm	1150 mm	800 mm	1800 mm
Min. fork height	75 mm	85 mm	85 mm	85 mm
Max. fork height	190 mm	200 mm	200 mm	200 mm
Lifting height	115 mm	115 mm	115 mm	115 mm
Steering angle	210°	210°	210°	210°
Steering roller Ø	180 x 50 mm	200 x 50 mm	200 x 50 mm	200 x 50 mm
Fork roller Ø	73 x 55 mm	80 x 70 mm	80 x 70 mm	80 x 70 mm
Weight	55 kg	84 kg	71 kg	122 kg

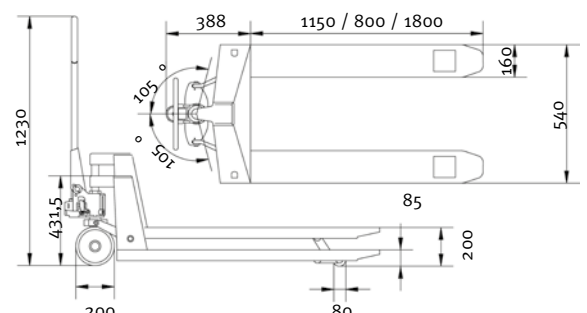

\* The prices quoted here are non-binding. We reserve the right to adjust our prices in case of a change in import regulations.

## PHW 2002 WE, PHW 2002 W, PHW 2002 WP – Professional hand lift truck with a lifting capacity of 2 t and integrated electronic scales – optionally with printer

- Integrated electronic scales in a high-quality steel housing
- With a large, six-digit LCD display for pounds or kilograms and grams, also easily readable from the side
- WE model shows the total weighing range in steps of 5 kg on the scales display (measuring tolerance of 0.8 % over the measuring range)
- W and WP models show the total weighing range in steps of 1 kg on the scales display (measuring tolerance of 0.1 % over the measuring range)
- With error message display
- Electronic parts for reliability, DIN IP65-protected against humidity and dust
- Reliable at temperatures from -10° to 40° C and 10% to 95% relative humidity
- Tare correction, gross/net weight, total weight and totalling function for serial weighing
- External power supply with 1.5 V batteries

### PHW 2002 WP

- Additionally with integrated printer for weight output

### PHW 2000 WE **Neu**

- integrated load indication system with a compact LCD indicator (user friendly with only 2 keys for operation and with zero setting and totalling function)
- Manual zero correction
- Totalling with sequence number
- Visual overload alert
- Error messages in display.
- Easy and economic overload control for lorries
- Simple and fast incoming weight control



- PHW 2002 WE with weight display in steps of 5 kg
- Large, easy-to-operate 2-key control panel



- PHW 2002 WP including integrated printer for weight output
- Self-explanatory large 4-button control panel with tactile click when pressing the button
- Also very easy to operate when wearing gloves



**PHW 2002 WE**  
**PHW 2000 WE**  
(similar to illustration)



**PHW 2002 W**



**PHW 2002 WP**

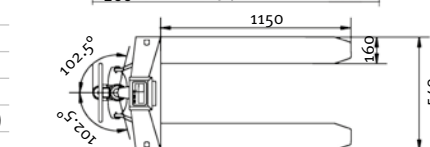
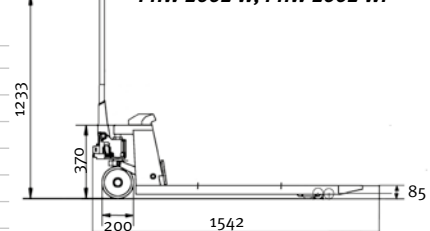
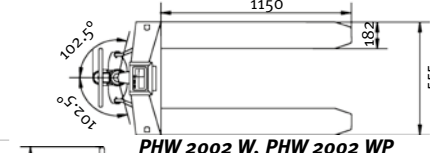
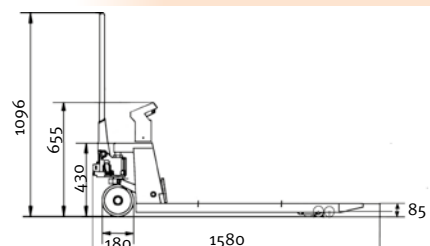

**PHW 2002 WE**

Model	PHW 2002 WE	<b>Neu</b> PHW 2000 WE	PHW 2002 W	PHW 2002 WP
Article no.:	615 0264	615 0265	615 0262	615 0263
<b>Technical data</b>				
Load-bearing capacity	2 t	2 t	2 t	2 t
Total width	540 mm	540 mm	555 mm	555 mm
Fork width	160 mm	160 mm	182 mm	182 mm
Fork length	1150 mm	1150 mm	1150 mm	1150 mm
Min. fork height	85 mm	85 mm	85 mm	85 mm
Max. fork height	200 mm	200 mm	200 mm	200 mm
Lifting height	115 mm	115 mm	115 mm	115 mm
Steering angle	205°	205°	205°	205°
Steering roller Ø	200 x 50 mm	200 x 50 mm	180 x 50 mm	180 x 50 mm
Fork roller Ø	74 x 70 mm	78 x 70 mm	74 x 70 mm	74 x 70 mm
Weight	80 kg	80 kg	130 kg	132 kg
Batteries	2 x battery 1.5 V (AA)	2 x battery 1.5 V (AA)	4 x battery 1.5 V (AA)	4 x battery 1.5 V (AA)

(included in scope of supply)





- The lift, quick lift, lower functions and neutral position are set via the one-hand lever
- Optimum comfort due to plastic coating



- Fully-hydraulic lifting and lowering device with 3 hard chrome-plated pistons and pressure relief valve
- The lowering speed is automatically reduced for heavy loads
- Fast mechanical stroke to reach maximum fork height



- During pumping, the lifting truck is supported by its factory-standard support feet as of a certain height. This ensures stability and stops the lifting truck rolling away



- The PHH 1001 is universally deployable thanks to its low chassis height of just 430 mm

### PHH 1001 – Combined scissor pallet truck

The mobile lifting platform with a load-bearing capacity of 1 t

- Robust fully-hydraulic lifting and lowering device
- Smooth-action hydraulic pump with hard chrome-plated piston and pressure relief valve
- Lowering speed infinitely variable thanks to release valve with granular control
- Fast mechanical stroke to reach maximum fork height of 800 mm
- Stable, torsion-resistant monocoque design of frame and forks
- Easily manoeuvrable thanks to steering angle of up to 210°
- Ergonomically shaped drawbar, non-slip with additional plastic coating
- Move heavy loads easily by switching from pumping to neutral position
- Extremely quiet action thanks to aluminium steering rollers with inflatable full-rubber treads
- Maintenance-free precision ball bearings in all wheels and rollers



<b>Model</b>	<b>PHH 1001</b>
Article no.	615 0100
<b>Technical data</b>	
Load-bearing capacity	1 t
Total width	540 mm
Fork width	160 mm
Fork length	1150 mm
Min. fork height	85 mm
Lifting height	715 mm
Chassis height	430 mm
Steering angle	210°
Steering roller Ø	180 x 50 mm
Fork roller Ø	74 x 50 mm
Weight	122 kg

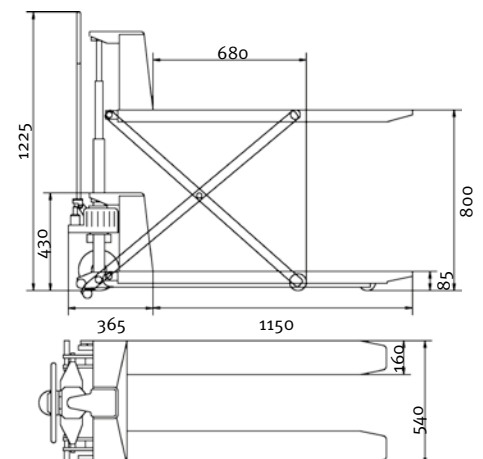



## PHH 1002 E – Combined scissor pallet truck with electrohydraulic lifting device; load-bearing capacity 1 t

- Robust electrohydraulic lifting and lowering device
- Hydraulic pump with hard chrome-plated piston and pressure relief valve
- Dual use as electric or manually-driven scissor pallet truck, e.g., while charging the battery
- Manual lowering; smooth, continuous lowering speed adjustment thanks to release valve with granular control
- Maximum fork height of 800 mm
- Stable, torsion-resistant monocoque design of frame and forks
- Ergonomically shaped drawbar, non-slip with additional plastic coating
- Easily manoeuvrable thanks to wide steering angle of up to 210°
- Extremely quiet action thanks to aluminium steering rollers with inflatable full-rubber treads and polyurethane fork rollers
- Maintenance-free precision ball bearings in all wheels and rollers
- Features a maintenance-free battery with an operating time of five hours (12 V/60 Ah) and charger as factory standard



### Scope of delivery:

- Battery 12 V
- Battery charger



- The ergonomically shaped drawbar supports single-handed operation and is also plastic-coated for optimum convenience



- Robust electrohydraulic lifting and lowering device
- The lowering speed is automatically reduced for heavy loads to avoid damage
- LED battery charge display



- Premium, smooth-action hydraulic pump with hard chrome-plated piston and pressure relief valve



- During pumping, the lifting truck is supported by its factory-standard support feet as of a certain height - this ensures stability and stops the lifting truck rolling away

<b>Model</b>	<b>PHH 1002 E</b>
Article no.	615 0103
<b>Technical data</b>	
Load-bearing capacity	1 t
Total width	540 mm
Fork width	160 mm
Fork length	1170 mm
Min. fork height	85 mm
Lifting height	800 mm
Chassis height	385 mm
Steering angle	210°
Steering roller Ø	180 x 55 mm
Fork roller Ø	75 x 50 mm
Battery capacity	12 Volt / 60 Ah
Motor output	0.8 kW
Weight without battery	169 kg

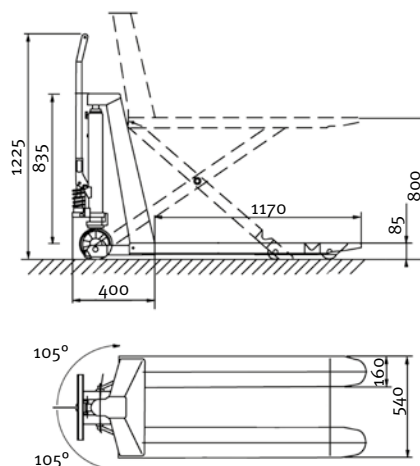

## GHHW 1000 – Pallet stackers

- Perfect for loading and unloading vehicles
- Facilitates handling and transport in the warehouse and at the workplace
- Dual use for stacking and short transport tasks
- No sparks due to static charge and no electromagnetic fields; thus also suitable for flammable or explosive materials
- Robust steel section design with premium welds
- Fixed fork width for stable lifting of the load
- Economically designed lifting device with manually-actuated hydraulic pump
- Easily fits through doors and cramped warehouses thanks to its compact design
- Equipped with low-wear rollers and rotating, ball-bearing borne, nylon rear wheels for easy action
- Durably precision-engineered
- The lifting function is easy to use thanks to foot and hand levers



- Foot pedal takes the hard work out of lifting



- Rugged design with large steering rollers and twin polyurethane load-bearing rollers
- No sparks due to static charge and no electromagnetic fields; thus also suitable for flammable or explosive materials



- Ergonomically shaped handle for single-handed operation
- Optimum comfort due to plastic coating

Model	GHHW 1000
Article no.	615 1016
<b>Technical data</b>	
Load-bearing capacity	1 t
Total width	755 mm
Total length	1705 mm
Fork dimensions	61 x 170 x 1150 mm
Ground clearance	90 mm
Lifting height	1600 mm
Chassis height	1980 mm
Steering angle	210°
Steering roller Ø	147 x 40 mm
Twin fork roller Ø	83 x 60 mm
Net weight	230 kg
Lifting speed	25 mm/s
Lowering speed	manually controllable
Turning circle	1380 mm
Aisle width needed	2112 mm
Load distribution	600 mm
Weight	230 kg

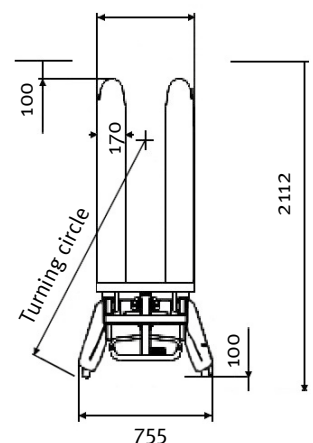
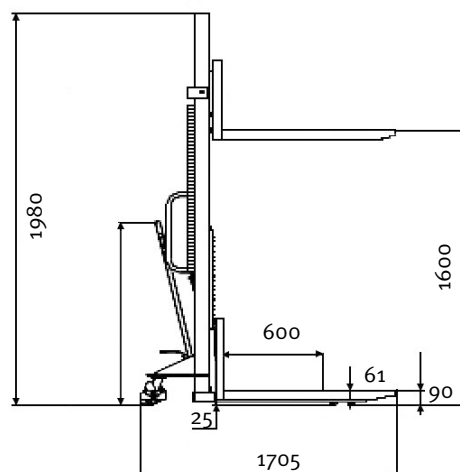

## UF 230 – Universal chassis with 230 kg load-bearing capacity

- For easy transport and relocation of your machines
- Safe and stable design
- Fast and easy assembly
- Wheels rotate through 360° for ease of movement
- Grid supports various size settings
- With vibration damping feet
- With two steering rollers and clasp brake as factory standard

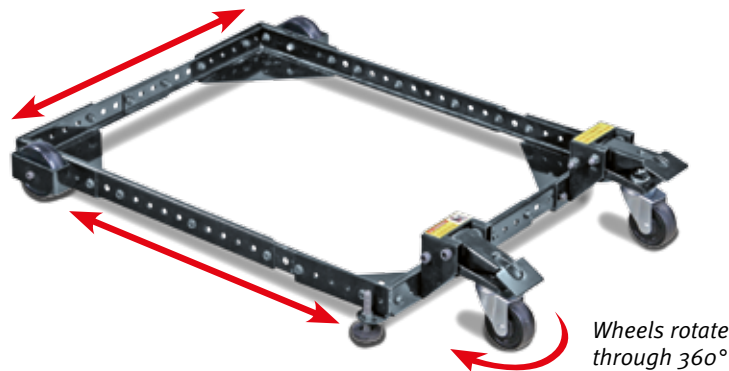

<b>Model</b>	<b>UF 230</b>
Article no.	619 0230
<b>Technical data</b>	
Load-bearing capacity	230 kg
Size min square	280 x 280 mm
Size max. square	890 x 890 mm
Size min rectangular	430 x 280 mm
Size max. rectangular	1290 x 480 mm
Grid spacing	25 mm
Weight	7.7 kg



### Typical applications

For easy moving of band saws, sanding machines, planes, drills, etc. (machines not included in scope of supply)

## HR 1000 – Lifting rollers with 1 t load-bearing capacity

- Set of 2 with lever bar
- For transporting heavy objects such as cabinets, etc.
- Electro-galvanised steel sheet frame
- Contact surfaces rubber coated, wheels with polyurethane tyres

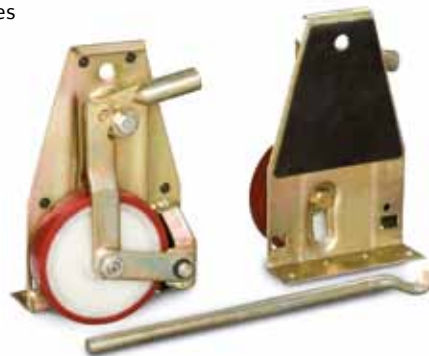

### Typical application

Perfectly suited for easy load shifting (cabinet not included in scope of supply)

<b>Model</b>	<b>HR 1000</b>
Article no.	619 1000
<b>Technical data</b>	
Load-bearing capacity	1 t (per set)
Polyurethane wheels	138 x 28 mm
Claw height bottom	12 mm
Claw height top	50 mm
Weight	approx. 10 kg (per set)

### Easy handling:

- Lift the load with the lever bar
- Push the claw on the lifting roller underneath
- Lift the load by using the lever bar to switch the eccentric lever
- Follow the same steps with the second lifting roller on the other side



## ETR 4/150 – Corner transport rollers with 150 kg load-bearing capacity

- For fast and easy moving of box-shaped objects and furniture
- Low loading height for safe transport
- Housing made of welded steel sheet
- Loading surface with anti-slip mat
- Scope of supply includes 4 corner rollers

Model	ETR 4/150
Article no.	619 7150
<b>Technical data</b>	
Load-bearing capacity	150 kg
Wheels	3 solid rubber steering rollers
Dimensions (LxWxH)	255 x 255 x 85 mm
Loading height	15 mm
Weight	2 kg/pc.



Rotate through 360°



### Typical application

Perfectly suited for easy shifting of box-shaped objects (cabinet not included in scope of supply)

## HS Series – Lever bars with 1.5 t and 5 t load-bearing capacity

- Solid steel bar for maximum stability
- Easy-action steel rollers

Model	HS 1.5	HS 5
Article no.:	619 6015	619 6050
<b>Technical data</b>		
Load-bearing capacity	1.5 t	5 t
Lever length	2000 mm	2200 mm
Number of rollers	2	2
Roller size	70 x 54 mm	70 x 54 mm
Weight	approx. 16 kg	approx. 32 kg



## TR Series – Transport rollers with 3 t and 6 t load-bearing capacity

- For easy and safe shifting of heavy objects
- Large ball-bearing borne nylon rollers and anti-slip rubber surface

Model	TR 3	TR 6
Article no.:	619 3030	619 3060
<b>Technical data</b>		
Load-bearing capacity	3 t	6 t
Dimensions (LxWxH)	400 x 228 x 100 mm	420 x 340 x 120 mm
Number of rollers	4 each	6 each
Roller size	85 x 90 mm	85 x 85 mm
Weight	approx. 9.5 kg	approx. 12 kg



## VTR Series – Adjustable transport rollers

- Set of 2
- Large ball-bearing borne nylon rollers
- Adjustable using 2 steel bars from 500 mm to 1400 mm (VTR 6) or from 720 mm to 1500 mm (VTR 12)
- Anti-slip rubber surface

Model	VTR 6	VTR 12
Article no.:	619 2060	619 2120
<b>Technical data</b>		
Load-bearing capacity	6 t	12 t
Dimensions (LxWxH)	320 x 268 x 110 mm	420 x 268 x 110 mm
Number of rollers	4 each	6 each
Roller size	85 x 90 mm	85 x 90 mm
Weight (per block of rollers)	approx. 30 kg	approx. 38 kg



### Scope of delivery:

Two transport rollers with two steel bars

Transport rollers can be connected up to a length of 1.40 m (VTR 6) or 1.50 m (VTR 12)



## TF Series – Transport chassis

- For easy and safe transport and relocation of heavy objects and machines
- With pivoting carrier plate (single for TF 3, dual for TF 6 and TF 12) and drawbar for easy manoeuvring around corners
- Carrier plate with anti-slip rubber surface

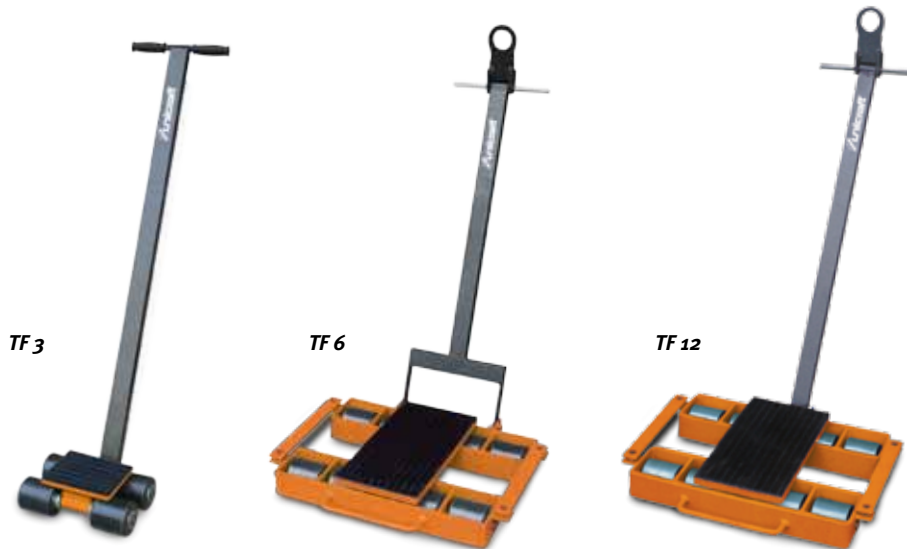

Model	TF 3	TF 6	TF 12
Article no.:	619 1030	619 1060	619 1120
<b>Technical data</b>			
Load-bearing capacity	3 t	6 t	12 t
Dimensions (without drawbar)	295 x 230 x 104 mm	640 x 534 x 115 mm	640 x 566 x 115 mm
Number of rollers	4	8	8
Roller size	85 x 90 mm	85 x 90 mm	83 x 95 mm
Weight	approx. 15 kg	approx. 50 kg	approx. 66 kg

## TR 20 – Transport roller set with 20 t load-bearing capacity

- For short transport paths
- Flexibly deployable for moving heavy loads
- Easy to steer with turning circle of 3 m



Model	TR 20
Article no.	619 5020
<b>Technical data</b>	
Load-bearing capacity	20 t
Compensating upper part	120 x 120 mm
Height	108 mm
Roller Ø	18 mm
Turntable upper part	Ø 130 mm
Weight	approx. 50 kg

### Scope of delivery:

- 4 Transport rollers
- 2 rotating round carrier plates
- 2 rectangular carrier plates
- 2 connecting rods
- 2 steering rods
- 1 drawbar
- 1 metal box with rollers and handles

## HSWH Series – Hydraulic bottle jacks with 3 t or 5 t load-bearing capacity

- Jack with grooved lifting pad and screw extension
- Extremely durable cylinder
- Very low insertion height in lowest position
- Extremely stable and tilt-safe thanks to large special cast base plate for added stability
- Easy-action, two-part pump rocker arm with fit for valve control
- Particularly robust, stable and durable thanks to reinforced walls

Model	HSWH 3	HSWH 5
Article no.	620 1000	620 1001
<b>Technical data</b>		
Load-bearing capacity	3 t	5 t
min height (A)	194 mm	216 mm
Lifting height (B)	118 mm	127 mm
Adjustment height (C)	60 mm	70 mm
Max. height (D)	372 mm	413 mm
Footprint (ExF)	92 x 100 mm	96 x 112 mm
Weight	3.6 kg	4.5 kg

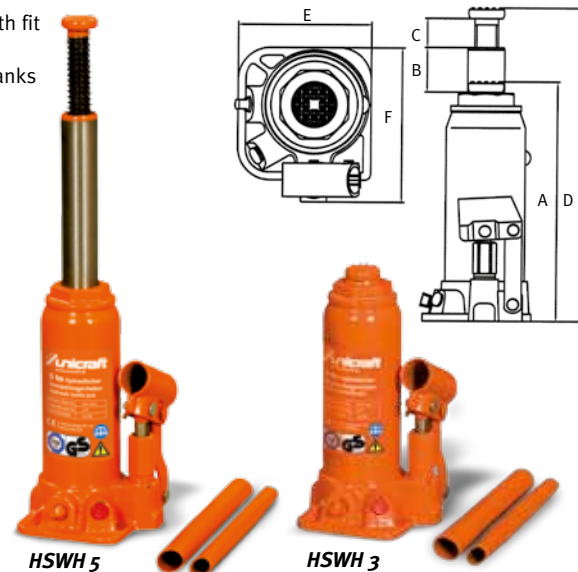

## HSWH-Pro Series – Hydraulic bottle jacks for professional use

- Safety valve protects the cylinder against overload
- Inner safety valve prevents inadvertent adjustment
- Hard chrome-plated piston and adjusting screw with smooth surface for long service life
- Long galvanized lever for easy pumping
- Premium welds and extremely durable threaded joint for maximum leak-tightness
- Reinforced at points exposed to heavy loads
- Stop protection prevents over-extension and blocking of the piston
- Pump is doubly sealed to improve leak-tightness
- The extremely robust welded chassis is suitable for toughest permanent operation
- Rounded base ensures central load distribution

Model	HSWH-Pro 5	HSWH-Pro 10	HSWH-Pro 20	HSWH-Pro 30
Article no.	620 1015	620 1016	620 1017	620 1018
<b>Technical data</b>				
Load-bearing capacity	5 t	10 t	20 t	30 t
min height (A)	212 mm	220 mm	241 mm	244 mm
Adjustment height (B)	110 mm	115 mm	115 mm	108 mm
Lifting height (C)	146 mm	148 mm	165 mm	140 mm
Max. height (D)	468 mm	483 mm	521 mm	492 mm
Piston Ø (E)	40 mm	48 mm	60 mm	65 mm
Footprint (F)	110 mm x 112 mm	124 mm x 127.5 mm	165 mm x 161 mm	186 mm x 174 mm
Dimensions (LxWxH)	110 x 112 x 468 mm	124 x 127.5 x 483 mm	165 x 161 x 521 mm	186 x 174 x 492 mm
Weight	4.9 kg	7.4 kg	13.1 kg	15.8 kg



## UB Series – Trestles

- Safeguard for working under the raised vehicle
- Robust welded design with V piston
- Wide feet: easy on the workshop floor, asphalt or other substrates
- UB 3000 adjustable in ten stages
- UB 6000 adjustable in 13 stages
- Scope of delivery: 2 pcs.



Model	UB 3000	UB 6000
Article no.	620 1300	620 1301
<b>Technical data</b>		
Load-bearing capacity	3 t /trestle	6 t/trestle
Min height	288 mm	395 mm
Max. height	425 mm	605 mm
Latching stages	10	13
Footprint	225 x 205 mm	310 x 265 mm
Weight	7 kg (per pair)	13.2 kg (per pair)

## UBK Series – Folding trestles

- Safeguard for working under the raised vehicle
- Wide feet: easy on the substrate
- Scope of delivery: 2 pcs.



Model	UBK 3000	UBK 6000
Article no.	620 1305	620 1306
<b>Technical data</b>		
Load-bearing capacity	3 t/trestle	6 t/trestle
Min. height	285 mm	376 mm
Max. height	400 mm	576 mm
Latching stages	4	4
Footprint	240 x 240 mm	370 x 370 mm
Weight	4 kg/pair	4.3 kg/pair

## RWH Series – Floor jacks

- With cast iron load-bearing and steering rollers

### RWH 2

- Short type
- Compact and stable
- Practical carrying handle



RWH 2

### RWH 2.5

- With upper part for extending the pad
- With second attachment point for lever: single stroke on the vehicle's jacking point thanks to QUICK LIFT function
- Easy lifting after moving the lever



**QUICK LIFT  
function**

RWH 2.5



- With practical holder for upper part at side



- Extensible pad facilitates work on the vehicle

## RWHA Series – Aluminium floor jacks

Light models for flat, sports vehicles

- Very flat, designed specifically with vehicles with lowered suspension
- Valve control via interior rods and rotary button on pump lever
- Slow, safe lowering under load
- Convenient and easy lifting thanks to hydraulics and long lever
- Two practical aluminium handles at sides



RWHA 1500

RWHA 2500

### RWHA 1500

- Lightweight, robust aluminium design
- With stable load roller
- Rubber mat protects pad and vehicle

### RWHA 2500

- Robust aluminium and steel construction



- For low chassis



- Rubber mat on pad and pump lever sleeve protect the vehicle chassis

Model	RWH 2	RWH 2.5	RWHA 1500	RWHA 2500
Article no.	620 1100	620 1101	620 1106	620 1109
<b>Technical data</b>				
Load-bearing capacity	2 t	2.5 t	1.5 t	2.5 t
Ground clearance min.	130 mm	150 mm	85 mm	100 mm
Final height max.	345 mm	530 mm	445 mm	465 mm
Dimensions (LxWxH)	480 x 220 x 150 mm	680 x 290 x 185 mm	660 x 294 x 170 mm	650 x 292 x 170 mm
Weight	9.6 kg	18 kg	19.5 kg	26.4 kg



#### SRWH 2500 EF



- **Flat design:** Floor jack specially designed for suspension lowered and sports vehicles with a minimum ground clearance of just 85 mm

#### SRWH 3000 QL



- **QUICK LIFT function:** with a single push of the pedal at the vehicle's jacking point

#### Serie SRWH LF



- **Integrated helper:** practical tool tray



- **Long design:** very useful with long frames

## SRWH Series – Special floor jacks

### SRWH 2500 EF, SRWH 3000 EF, SRWH 3000 QL

- Two-part pump lever with rubber handle for safe and easy lifting of loads
- Valve control via rotating pump lever
- With cast iron load-bearing and steering rollers
- Extra-wide support pad surface

#### SRWH 2500 EF



#### SRWH 3000 EF



### QUICK LIFT function

#### SRWH 3000 QL



### SRWH 2000 F, 2000 LF, SRWH 3000 LF

- Particularly well-suited for long frame parts due to extra-long design
- With extra-low pad profile for suspension-lowered vehicles
- Easy lifting up to jacking point via foot pedal or hand lever

- Slow, safe lowering under load
- Large support pad with rubber mat protects the jacking point and vehicle
- Practical integrated tool tray with rubber mat
- With cast iron load-bearing and steering rollers

#### SRWH 2000 F



#### SRWH 2000 LF



#### SRWH 3000 LF



Turn to lower



Turn to lower

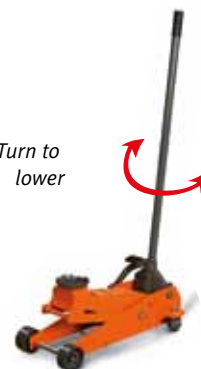

Turn to lower



Turn to lower



	Extra flat!	Extra flat!				
Model	SRWH 2500 EF	SRWH 3000 EF	SRWH 3000 QL	SRWH 2000 F	SRWH 2000 LF	SRWH 3000 LF
Article no.	620 1102	620 1113	620 1103	620 1114	620 1104	620 1105
Technical data						
Load-bearing capacity	2.5 t	3.0 t	3.0 t	2.0 t	2.0 t	3.0 t
Ground clearance min.	85 mm	98 mm	145 mm	70 mm	76 mm	140 mm
Final height max.	455 mm	535 mm	500 mm	500 mm	510 mm	525 mm
Dimensions (LxWxH) in mm	640 x 342 x 174	780 x 345 x 170	685 x 346 x 180	785 x 350 x 205	1006 x 365 x 136	1154 x 360 x 190
Weight	34.8 kg	44.5 kg	38 kg	40 kg	42 kg	45 kg



## SRWH-PRO 2000 and SRWH-PRO 1500 L – professional special floor jacks

- Robust frame design
- Compact and space-saving
- Large support pad for best possible safety when lifting loads
- Rapid centring of the load thanks to the lifting pad shape
- Load-bearing and steering rollers made of plastic for low-noise positioning
- SRWH-PRO 1500 L, 1085 mm length for maximum free space under the vehicle
- Safety valve triggers lifting bar idle position in case of overload - lifting height is kept
- Lifting bar with ergonomically-shaped, rubber-coated handle
- Rotating pump lever



**SRWH-PRO 2000**

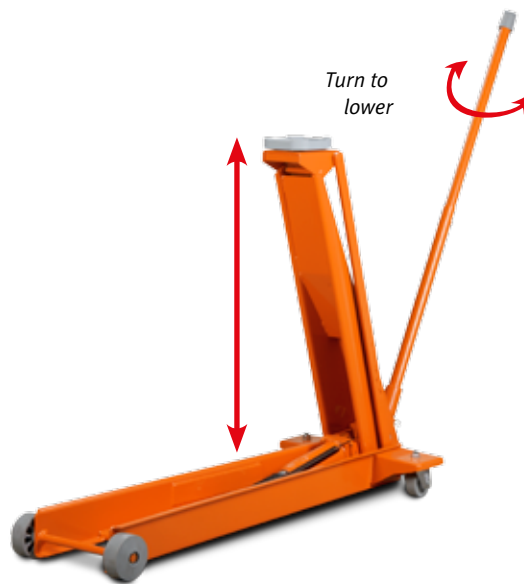

**SRWH-PRO 1500 L**  
for high lifting



**SRWH-PRO 2000**



**SRWH-PRO 1500 L**  
1085 mm length for maximum  
free space under the vehicle

Model	SRWH-PRO 2000	SRWH-PRO 1500 L
Article no.	620 1115	620 1116
<b>Technical data</b>		
Load-bearing capacity	2.0 t	1.5 t
Max. lifting height	405 mm	720 mm
Min. lifting height	130 mm	135 mm
Dimensions (LxWxH)	760 x 480 x 200 mm	1120 x 480 x 200 mm
Weight	33.5 kg	50 kg

## Series WWH – Special floor jacks Pneumatic-hydraulic workshop jacks

- Controlled, safe lifting and lowering, powered by compressed air
- Works with compressed air from compressor at 6 - 10 bar
- Compact design with stable rollers made of cast iron and PU coated
- T-handle for easier manoeuvring
- Two additional cast-iron upper parts in heights of 75 and 45 mm
- Hard chrome-plated piston with extra-smooth surface

Included in scope of supply: upper parts 45 mm and 75 mm



- Intuitive safety rotary button control with compressor coupling



For matching compressors see the main Aircraft catalogue, or visit [www.aircraft-kompressoren.com](http://www.aircraft-kompressoren.com)



Model	WWH 40000 PH	<b>New</b> WWH 60000 PH
Article no.	620 1107	620 1112
<b>Technical data</b>		
Load lifting capacity	20 / 40 t	20 / 40 / 60 t
Air pressure	6 - 10 bar	6 - 10 bar
Min height	210 mm	150 mm
Extended height 20 / 40 / 60 t	111 / 126 mm	56 / 49 / 57 mm
Additional upper parts	75 / 45 mm	75 / 45 mm
Weight	56 kg	64 kg
Dimensions	580 x 275 x 447 mm	1480 x 350 x 120 mm

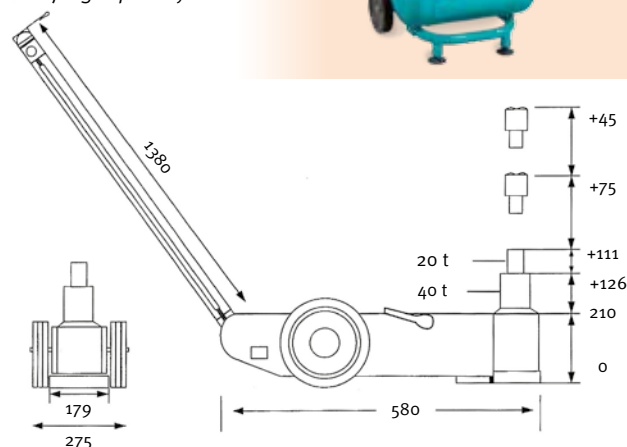

## PV 680 – Carmover: hydraulic chassis as vehicle positioning aid

- Move vehicles with ease, including damaged, locked, or blocked vehicles
- Lateral movement and rotating on the spot possible
- Perfect for manoeuvring in cramped spaces, e.g., car dealerships or workshops
- Easy action via foot pedal, no need to bend
- Lightweight aluminium design with 680 kg load bearing capacity
- With steering rollers for best manoeuvring ability

Model	PV 680
Article no.	620 1600
<b>Technical data</b>	
Load lifting force (top position)	680 kg
Dimensions (LxWxH)	68 x 65 x 22 mm
Weight	19.5 kg



Typical application

## KR 2000 – Vehicle ramps: practical drive-on ramps

- Extremely robust welded steel design, loadable up to 2 t
- More safety at work on and under the vehicle,
- and ease of use
- Extra-wide design with 210 mm drive-on width

<b>Model</b>	<b>KR 2000</b>
Article no.	620 2000
<b>Technical data</b>	
Load-bearing capacity	2 t (pair)
Dimensions (LxWxH)	850 x 325 x 275 mm
Weight	5.2 kg per pc.

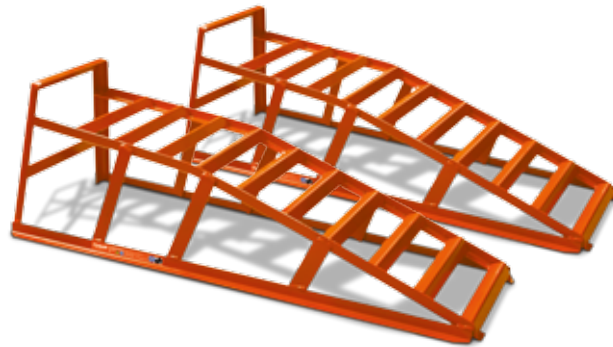

Fig. shows scope of supply (2 pcs.)

## MH 680 – Ultra-compact motorcycle lifting platform with retaining straps

- For motorcycle and quad repairs
- Excellent stability and load-bearing capacity up to 680 kg despite compact dimensions
- Perfectly suited for smaller workshops, foldable to save storage space
- The retaining straps included guaranteed safe work
- Steering rollers with clasp brakes
- Easy-to-operate foot pedal

<b>Model</b>	<b>MH 680</b>
Article no.	620 1500
<b>Technical data</b>	
Load-bearing capacity	680 kg
Min. height	140 mm
Max. height	410 mm
Dimensions (LxWxH)	864 x 396 x 315 mm
Weight	35 kg



## MHB 400 – Motorcycle lifting platform with foot pump for easier lifting

- Stable design for motorcycle repairs
- Ideal for repairs on small-engine motorcycles, scooters, and motorcycles up to a maximum weight of 400 kg
- Compact design, thus perfectly suited for smaller workshops
- With wide base and ramp for easier manoeuvring of the vehicle

<b>Model</b>	<b>MHB 400</b>
Article no.	620 1501
<b>Technical data</b>	
Load-bearing capacity	400 kg
Min. height	180 mm
Max. height	760 mm
Dimensions (LxWxH)	2200 x 654 x 180 mm
Weight	135 kg



## WK 2000 – Workshop crane

- Folding tubular feet save space
- Load-bearing capacity depending on outreach 0.5 to 2 t

Model	WK 2000
Article no.	620 1401
<b>Technical data</b>	
Load-bearing capacity	0.5-2 t
Lifting height	25 to 2300 mm
Dimensions (LxWxH)	1800 x 1040 x 1568 mm
Weight	111.5 kg



## MMB 500 – Engine mounting gantry

- Assembly crossbeam with stable safety chain and manually adjustable threads
- Supports fast, safe engine positioning
- Trouble-free attaching of gearbox possible from underside without additional safeguards
- For bearing transverse and straight engines in the chassis
- Swivelling supporting feet with manually lockable rotary knobs for optimum accommodation of any engine compartment slope

Model	MMB 500
Article no.	620 1700
<b>Technical data</b>	
Load-bearing capacity	0.5 t
Adjusting range	150 mm
Axle length	1500 mm
Dimensions (LxWxH)	1540 x 150 x 110 mm
Weight	22 kg



## MP 680 – Engine positioner

- For engine fitting/removal in combination with workshop cranes, or similar
- Quickly find centre of gravity thanks to practical crank and worm thread
- Four stable chains as practical attachment options
- Handy thanks to light weight

Model	MP 680
Article no.	620 1701
<b>Technical data</b>	
Load-bearing capacity	680 kg
Dimensions (LxWxH)	445 x 65 x 190 mm
Weight	5.5 kg



## GH Series – Hydraulic gearbox lift, infinitely height-adjustable

- Ideal for fitting and removing gearboxes, axles, exhaust systems, and for other service and maintenance work
- Lifting by means of a hydraulic, infinitely height-adjustable foot pump that allows for free work or holding with the hands at the same time
- The load is lowered by means of a hand-held controller
- With 4 steering rollers for easy manoeuvring
- PRO types for professional use
- Gearbox lift GH 1500 PRO suitable for working on commercial vehicles

Model	GH 500	GH 600 Pro	GH 1500 Pro
Article no.	620 1402	620 1403	620 1404
<b>Technical data</b>			
Load-bearing capacity	0.5 t	0.6 t	1.5 t
Min. height	1135 mm	1130 mm	1195 mm
Max. height	1950 mm	1970 mm	1985 mm
Dimensions (LxWxH) in mm	1100 x 260 x 270	1130 x 330 x 230	1160 x 310 x 220
Weight	28 kg	34 kg	55.5 kg





## MMB 450 – Engine assembly trestle

- With steering rollers for best manoeuvring ability
- Adjustable in five stages up to 450 kg load-bearing capacity

<b>Model</b>	<b>MMB 450</b>
Article no.	620 1400
<b>Technical data</b>	
Max. load-bearing capacity	450 kg
Dimensions (LxWxH)	870 x 195 x 190 mm
Weight	21 kg



## MRB 40 KS and KRL 1 – Skateboards

### MRB 40 KS

- Wipe-clean plastic workshop creeper
- Ergonomic with padded head support
- Handle and six oil-resistant steering rollers
- Practical tray surfaces at sides

### KRL 1

- Workshop creeper foldable to assembly stool or for space-saving storage
- Robust steel design with padded lying/sitting surface and seven steering rollers



<b>Model</b>	<b>MRB 40 KS</b>	<b>KRL 1</b>
Article no.	620 1801	620 1802
<b>Technical data</b>		
Max. load-bearing capacity	120 kg	120 kg
Dimensions (LxWxH)	1010 x 475 x 130 mm	1020 x 400 x 140 mm (creeper) 485 x 400 x 440 mm (stool)
Weight	4.8 kg	6.7 kg



## MH 1 – Assembly stool

- Wipe-clean assembly stool
- Robust steel design with steering rollers
- Practical tool tray
- Pneumatically height-adjustable seat surface

<b>Model</b>	<b>MH 1</b>
Article no.	620 1900
<b>Technical data</b>	
Dimensions (LxWxH)	380 x 380 x 440 mm
Weight	5.7 kg



## MV Series – Mobile fans for industrial use

- Mobile fan with carrying handle and four rubber feet for low-vibration operation
- Suitable for dissipating hot air, welding fumes, saw dust, smoke, gases, smells, dust or other loaded air
- Useful for supplying fresh air to poorly ventilated places
- Useful for cooling, aerating, drying and ventilating large rooms such as factories, workshops, shop floors, building sites, etc.
- Facilitates the supply or extraction of air volumes over longer distances in combination with an optional 10 m hose



MV 30



MV 50



MV 60

Model	MV 30	MV 50	MV 60
Article no.:	626 0030	626 0050	626 0060
<b>Technical data</b>			
Cage ø	380 mm	580 mm	685 mm
Impeller ø	300 mm	500 mm	600 mm
Max. air flow	65 m³/min	150 m³/min	240 m³/min
Speed	2800 rpm	1400 rpm	1400 rpm
Output	500 ~ 550 W	1100 W	2000 W
Voltage	230 V / 50 Hz	230 V / 50 Hz	230 V / 50 Hz
Weight	15 kg	39 kg	64 kg
Dimensions (L x W x H)	420 x 380 x 380 mm	670 x 670 x 485 mm	770 x 770 x 575 mm

### Accessories



Hose ø 300 mm / 10 m

**Art. no.: 626 0130 99.00**

Hose ø 500 mm / 10 m

**Art. no.: 626 0150 169.00**

Hose ø 600 mm / 10 m

**Art. no.: 626 0160 179.00**

several hoses can be connected

## PLM 600, PLM 1000 – Permanent load lifting magnets

- Load-bearing capacity of up to 1 t depending on model despite light weight
- High standard of safety with simple lever switching action



PLM 600



PLM 1000

Model	New PLM 100*	New PLM 300*	PLM 600	PLM 1000
Article no.:	617 0001	617 0003	617 0006	617 0010
<b>Technical data</b>				
Load-bearing capacity	100 kg	300 kg	600 kg	1 t
Load-bearing capacity round material	50 kg	150 kg	300 kg	500 kg
Total length	130 mm	210 mm	265 mm	325 mm
Total width	60 mm	95 mm	115 mm	145 mm
Chassis height	120 mm	180 mm	220 mm	250 mm
Weight approx.	2,8 kg	11 kg	17,5 kg	37,5 kg

## K Series – Chain hoists

- Load-bearing capacity depending on model between 1 t and 10 t
- Robust steel sheet housing
- Closed safety design
- Easy to operate without applying force
- Single-, double-, or four-strand design
- Rotating load and attachment hook

Model	K 1000	K 2000	K 3000	K 5000	K 10000
Article no.	620 2101	620 2102	620 2103	620 2105	620 2110
<b>Technical data</b>					
Load-bearing capacity	1 t	2 t	3 t	5 t	10 t
Lifting height	2500 mm	2500 mm	3000 mm	3000 mm	3000 mm
Min. hook to hook distance	300 mm	380 mm	470 mm	600 mm	730 mm
Load lifting ability	330 N	330 N	390 N	420 N	450 N
Number of chain strands	1	2	2	2	4
Weight	9.4 kg	12.4 kg	21.7 kg	35 kg	65 kg



## USZ Series Universal cable winches

- For lifting, pulling and rigging work
- With overload protection
- Corrosion-free, impact-resistant housing
- Parallel clamping jaws protect the traction cable thanks to uniform load distribution
- Horizontal and vertical use
- Smooth-action cable guides, high speed

USZ 800



USZ 1600



USZ 3200



Model	USZ 800	USZ 1600	USZ 3200
Article no.	617 0508	617 0516	617 0532
<b>Technical data</b>			
Tensile load	800 kg	1600 kg	3200 kg
Lever force at nominal load	343 N	441 N	441 N
Cable feed/double stroke	52 mm	55 mm	28 mm
Cable -Ø	8.3 mm	11 mm	16 mm
Cable length	approx. 20 m	approx. 20 m	approx. 20 m
Weight	7.3 kg	14.5 kg	22 kg

Scope of supply incl. manual lever, cable on coiler with tip and hook

## HZ Series – Lever hoists with lifting chain

- For lifting and dragging work, also suitable for use in cramped conditions
- Chain freewheel position
- Easy to transport and store thanks to short lever
- Slip-safe thanks to rubberised handle
- Asbestos-free brake discs
- Robust, impact-resistant chain housing
- With rotating load hook

Model	HZ 750	HZ 1500	HZ 3200
Article no.	617 0675	617 0615	617 0630
<b>Technical data</b>			
Load-bearing capacity	0.75 t	1.5 t	3.2 t
Standard lifting height	1.5 m	1.5 m	1.5 m
Weight	7 kg	10 kg	17.5 kg
<b>Dimensions</b>			
A	325 mm	380 mm	480 mm
B	280 mm	410 mm	410 mm
C	148 mm	172 mm	200 mm
D	36 mm	44 mm	48 mm



HZ 1500

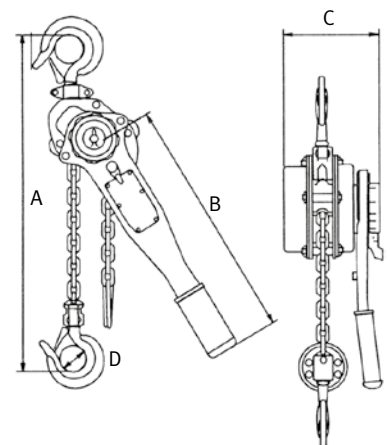

## ESW 900 – Electric cable winch, compact and robust, with 12 V connection

- For use in vehicles, e.g., for pulling machines up a ramp into a small transport
- Compact and robust
- Adjustable slip clutch protects the winch against overload
- Cable thickness Ø 5.6 mm
- Motor degree of protection IP 54



Model	ESW 900
Article no.	619 0900
<b>Technical data</b>	
Pulling force	900 kg
Cable length	9 m
Cable thickness Ø	5.6 mm
Rated current	25 A
Output	300 W
Current voltage	12 V DC
Pulling speed	0.6 m/min
Dimensions (LxWxH)	570 x 485 x 250 mm
Degree of protection	IP 54
Weight	13 kg



Typical application

## WSA – Wall swivel arm

- Matches electric cable hoists from the MES Series and others
- For fastening on rods or pipes  
Vertical bar not included in scope of supply  
(required dimension Ø 48 mm)

Model	WSA 250-1100	WSA 600-750	WSA 1000-750
Article no.	619 8599	619 8600	619 8601
<b>Technical data</b>			
Load lifting capacity max.	250 kg	600 kg	1000 kg
Outreach	1100 mm	750 mm	750 mm
Weight	7.6 kg	5.5 kg	6.7 kg
suitable for	MES 250/600	MES 250/600	MES 900

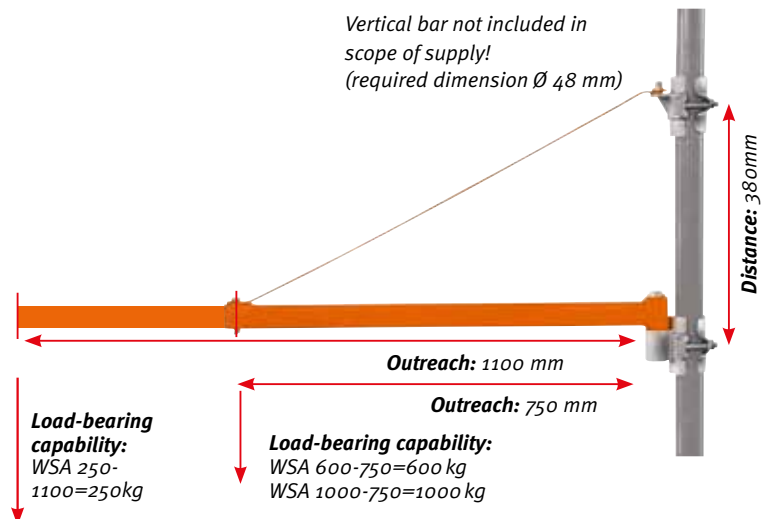

## MES Series – Mini electrical cable winches

- Dead-man switch for safe work
- Lifting height with/without deflection pulley 12 m/6 m
- Deflection pulley with load hook
- Operating switch with IP54 degree of protection
- Limit switch for immediate shut-off at top and bottom limit positions
- Fastened by means of two stable double-clamps
- Motor with overload protection to prevent overheating
- Remote control cable length 1.7 m

Model	MES 250	MES 600	MES 990
Article no.	619 8125	619 8160	619 8199
<b>Technical data</b>			
Load lifting capacity with/without deflection pulley	125 / 250 kg	300 / 600 kg	500 / 990 kg
Rated power	230 V ~50 Hz	230 V ~50 Hz	230 V ~50 Hz
Max. lifting speed with/without deflection pulley	10 / 5 m/min	10 / 5 m/min	8 / 4 m/min
Cable diameter	3.0 mm	4.5 mm	5.5 mm
Dimensions (LxWxH)	410 x 142 x 235 mm	465 x 150 x 253 mm	620 x 240 x 355 mm
Weight	12 kg	17.5 kg	33 kg





## ESW 250 – Electric cable hoist with 20 m lifting height

- Single-handed operation with 5 metre connection
- Mechanical gearbox brake holds the load when switched off
- Load hook with articulated joint
- Automatic emergency stop at end of cable
- Easy and fast installation
- With quick coupling for immediate use without time-consuming installation
- Powerful, maintenance-free electric motor

Model	ESW 250
Article no.	619 9250
<b>Technical data</b>	
Load lifting capacity	250 kg
Max. lifting height	20 m
Max. lifting speed	12 m/min
Cable diameter	4.2 mm
Length of cable, control unit	approx. 5 m
Power rating	230 V / 50 Hz
Output	1200 W
Dimensions (LxWxH) in mm	257 x 327 x 693
Overall weight	30 kg

## EKZT – Electric chain hoists with load hooks

- Overload protected thanks to slip clutch adjustable from exterior
- Electromagnetic brake
- Short and compact design
- Robust chains
- Phase protection

Model	EKZT 500	EKZT 1000	EKZT 2000
Article no.:	619 8050	619 8100	619 8120
<b>Technical data</b>			
Load-bearing capacity	0.5 t	1 t	2 t
Max. lifting height	6 m	6 m	6 m
Max. lifting speed	5 m/min	5 m/min	2.5 m/min
Chain hoist output	650 W	1100 W	1100 W
Power rating	230 V / 50 Hz	400 V / 50 Hz	400 V / 50 Hz
Length of cable, control unit	approx. 4.5 m	approx. 4.5 m	approx. 4.5 m
Dimensions (LxWxH)	690 x 410 x 470 mm	690 x 410 x 470 mm	690 x 410 x 470 mm
Weight	49 kg	49 kg	59 kg

## EKZF – Electric chain hoist with chassis

- Electronic chassis
- Low chassis height
- Overload protected thanks to slip clutch adjustable from exterior
- Electromagnetic brake
- Short and compact design
- Robust chains
- Phase protection
- With crane-trolley as factory standard
- Pendant control with emergency stop switch

Model	EKZF 500	EKZF 1000	EKZF 2000
Article no.:	619 9050	619 9100	619 9200
<b>Technical data</b>			
Load-bearing capacity	0.5 t	1 t	2 t
Max. lifting height	6 m	6 m	6 m
Max. lifting speed	5 m/min	5 m/min	2.5 m/min
Move speed max.	20 m/min	20 m/min	20 m/min
Chain hoist output	650 W	1100 W	1100 W
Crane-trolley output	450 W	600 W	600 W
Power rating	230 V / 50 Hz	400 V / 50 Hz	400 V / 50 Hz
Length of cable, control unit	approx. 4.5 m	approx. 4.5 m	approx. 4.5 m
Dimensions (LxWxH)	645 x 610 x 430 mm	645 x 610 x 430 mm	645 x 610 x 430 mm
Rail width	100 - 150 mm	100 - 150 mm	100 - 150 mm
Weight	118 kg	118 kg	123 kg



## KW Series – Crane scales

- Load-bearing capacity depending on model 5 t or 10 t
- High-precision as per OIML R 76 standard, calibration capable
- Tare over full range
- Operable both direct at the display, and via remote control
- With remote control with range of up to 10 m and calibrating function
- Bright, easily readable LED display with 30 mm digit height
- Value can be stored and frozen
- Easy to determine net weight thanks to tare function
- Totalling function for serial weighing
- Automatic switch-off function
- Overload warning in display
- Power supply via internal rechargeable battery 6V/10 Ah, included in scope of supply; easily to replace and charge



**KW 5**  
Front view

**KW 5**  
Fig. shows  
Scope of delivery

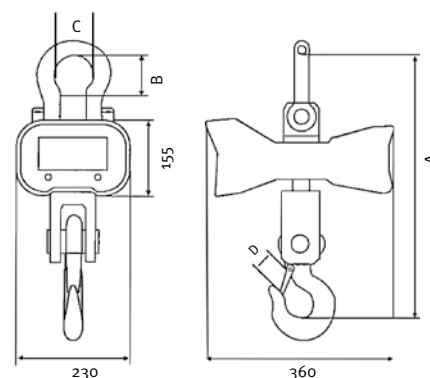

Model	KW 5	KW 10
Article no.:	617 0405	617 0410
<b>Technical data</b>		
Load-bearing capacity	5 t	10 t
Height (A)	585 mm	770 mm
Width	230 mm	230 mm
Shackle Ø (B)	135 mm	145 mm
Hook inside Ø (C)	92 mm	94 mm
Hook opening (D)	45 mm	60 mm
Display scale	< 2 t = 1 kg 2 t - 5 t = 2 kg	< 2 t = 1 kg 2 t - 5 t = 2 kg 5 t - 10 t = 10 kg
Stabilisation time	< 10 s	< 10 s
Overload max.	400 %	400 %
Weight	25 kg	47 kg

## SW Series – Steel winches

- Stable design as per DIN 7355
- Tested with 25 % overload
- Easy handling with low force for lifting loads
- Lifting support housing with helical toothed gear rod
- With self-arresting safety thrust roller crank
- Space-saving thanks to folding crank; thus also ideal for smaller workshops



**Foot**

Model	SW 3	SW 5	SW 10
Article no.:	617 0103	617 0105	617 0110
<b>Technical data</b>			
Load-bearing capacity	3 t	5 t	10 t
Height	730 mm	730 mm	800 mm
Lifting height	350 mm	345 mm	415 mm
Weight	20 kg	28 kg	46 kg
<b>Dimensions</b>			
A	83 mm	108 mm	124 mm
B	130 mm	140 mm	140 mm
C	730 - 1080 mm	730 - 1075 mm	800 - 1215 mm
D	75 - 425 mm	80 - 425 mm	90 - 505 mm
E	60 mm	71 mm	86 mm
F	45 mm	68 mm	76 mm
G	138 mm	170 mm	170 mm
H	249 mm	275 mm	300 mm
K	170 mm	190 mm	252 mm
R	140 mm	155 mm	185 mm
S	235 mm	217 mm	187 mm
T	128 mm	128 mm	250 mm

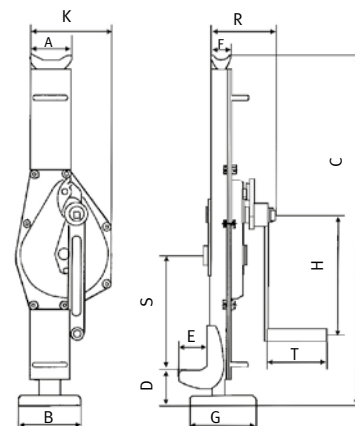
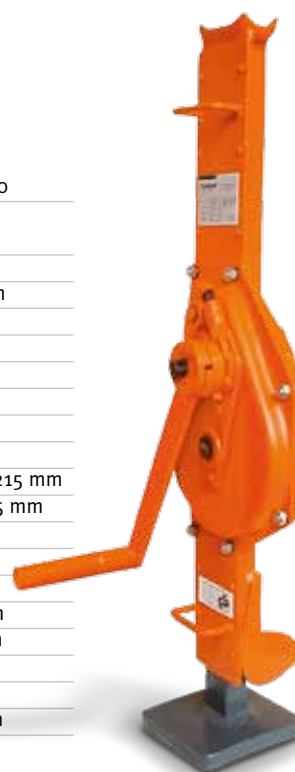

## MH Series – Machine lift

- For safe lifting of heavy loads
- Stable, welded steel design for demanding applications
- Lowering speed infinitely adjustable thanks to release screw with granular control
- Small and compact design
- Height-adjustable foot for MH3, MH8 and MH20



Model	MH 3	MH 8	MH 10	MH 20
Article no.	619 0003	619 0008	619 0010	619 0020
<b>Technical data</b>				
Bearing load max. A	-	-	10 t	20 t
Load lifting capacity max. B	-	-	7.5 t	15 t
Load lifting capacity max. C	3 t	8 t	6 t	12 t
Min. height	15 mm	20 mm	35 mm	40 mm
Lifting stroke	140 mm	140 mm	160 mm	140 mm
Weight	21 kg	28 kg	25 kg	68 kg

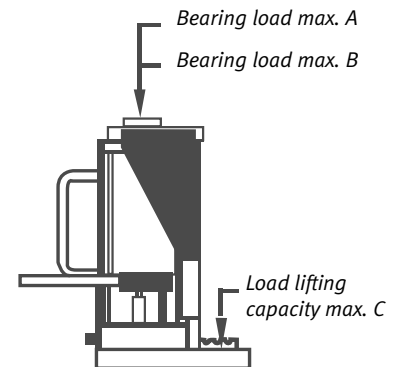

## HMH Series – Hydraulic machine lift

- Stable, welded steel design for demanding applications
- For safe lifting of heavy loads
- Pump unit rotatable
- 360° rotatable claw and/or base plate (HMH 5 / HMH 10)
- With chassis (HMH 25)
- Removable pump lever

Model	HMH 5	HMH 10	HMH 25
Article no.:	619 0050	619 0100	619 0250
<b>Technical data</b>			
Load-bearing capacity	5 t	10 t	25 t
Lifting height	205 mm	230 mm	215 mm
min. height/tooth	25 mm	30 mm	58 mm
min. height/head	368 mm	420 mm	505 mm
Load on lever	380 N	400 N	400 N
Temperature range	-20°C - + 50°C	-20°C - + 50°C	-20°C - + 50°C
Dimensions (LxWxH)	360 x 190 x 430 mm	380 x 220 x 510 mm	530 x 350 x 610 mm
Weight	25 kg	35 kg	109 kg



## WPP Series – Hydraulic workshop presses

WPP 10 HTE, WPP 10 TE, WPP 20 E, WPP 30 E

- Robust welded frame
- Ideal for versatile use in trades and for repairs in schools, training workshops, garages, workshops, farms, forestry and landscape gardening
- The series' rational design guarantees best-possible value for money
- The factory-standard integrated return spring ensures more space to work in
- Safe work: piston can be stopped in any position



### WPP 10 HTE

- Low-height table press
- Hydraulic pump: for manual pressure build-up via pump lever
- Scope of supply incl. two additional press pistons (short and long)

### WPP 10 TE

- The low table press is height-adjustable in three stages
- Pressure gauge shows compression
- Hydraulic pump: for manual pressure build-up via pump lever

### WPP 20 E

- Robust welded frame with perforations: press bench 10x height-adjustable with locking bolts
- Built-in hydraulic pump: manual pressure build up by actuating the pump lever
- With pressure gauge for reading off the compression
- Cylinder laterally translatable

### WPP 30 E

- Robust welded frame with perforations: press bench 10x height-adjustable with locking bolts
- With laterally translatable cylinder and pressure gauge for reading off the compression
- Piston stroke alternatively by hydraulic manual pump or pneumatic foot pedal
- Compressed air coupling for operating pressure 7,5 to 8,5 bar

Model	WPP 10 HTE	WPP 10 TE	WPP 20 E	WPP 30 E
Article no.	630 0010	630 0011	630 0020	630 0030
<b>Technical data</b>				
Compression force	10 t	10 t	20 t	30 t
Foot width x depth (AxB)	560 x 240 mm	574 x 450 mm	790 x 560 mm	790 x 700 mm
Height (C)	960 mm	1070 mm	1620 mm	1860 mm
Inside width (D)	410 mm	340 mm	550 mm	550 mm
Working range (E-F)	0 - 430 mm	0 - 330 mm	0 - 1000 mm	51 - 1131 mm
Piston stroke	150 mm	175 mm	190 mm	150 mm
Piston move path (G)	0 mm	0 mm	360 mm	200 mm
Operating pressure	7,5 - 8,5 bar	7,5 - 8,5 bar	7,5 - 8,5 bar	7,5 - 8,5 bar
Weight	45 kg	51 kg	135 kg	165 kg



## Hydraulic workshop presses

### WPP 50 E, WPP 75 E

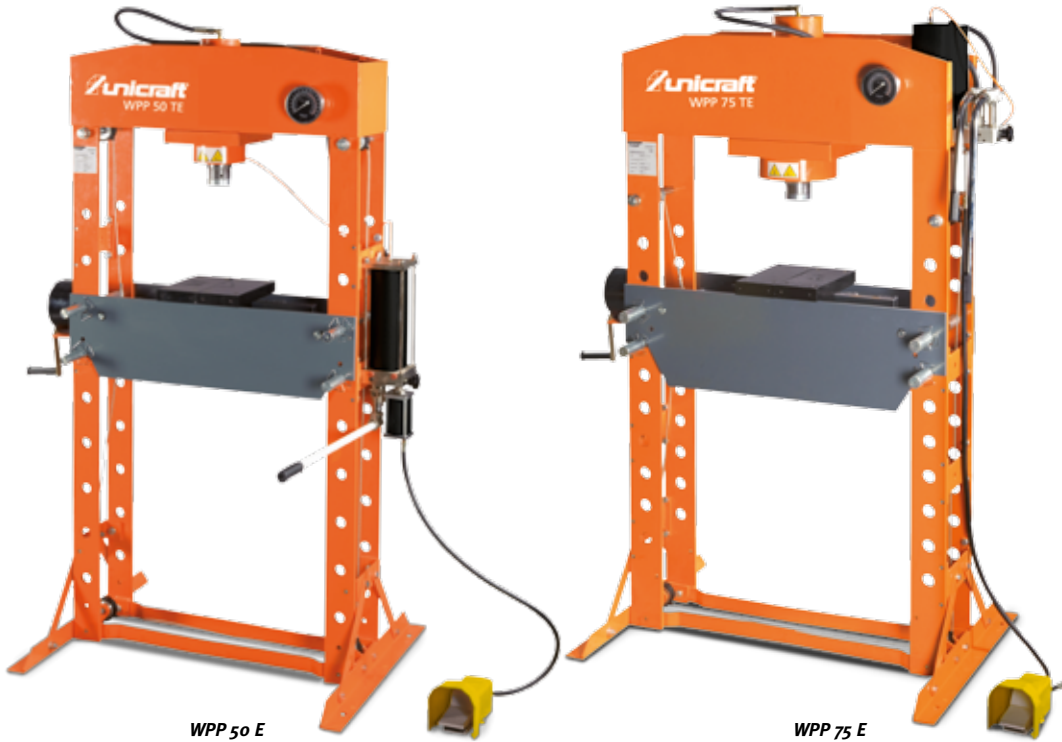

WPP 50 E

WPP 75 E

**WPP 50 E**

- 8x height-adjustable press bench with locking bolts
- With laterally translatable cylinder
- With pressure gauge for reading off the compression
- Piston stroke alternatively by hydraulic manual pump or pneumatic foot pedal

**WPP 75 E**

- 9x height-adjustable press bench with locking bolts
- Two-stage manual hydraulic pump
- With laterally translatable cylinder
- With pressure gauge for reading off the compression
- Piston stroke alternatively by hydraulic manual pump or pneumatic foot pedal

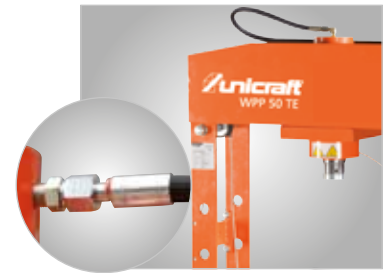

- Hydraulic hoses and couplings as per requirements of DIN 20066

**Accessories****Pressure barb set for WPP 20 E**

- 8-part, with perforated plate up to max. 20 t

Article no. 630 0001

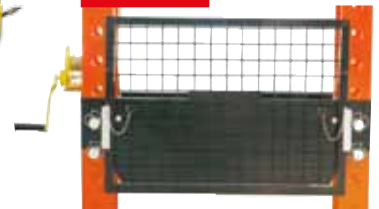
**Accessories**

Accessories	Article no.
<b>Grip guard</b>	
for WPP 10 TE	630 1005
for WPP 20 E	630 1006
for WPP 30 E	630 1007
for WPP 50 E	630 1008
for WPP 75 E	630 1009

Model	WPP 50 E	WPP 75 E
Article no.	630 0050	630 0075
<b>Technical data</b>		
Compression force	50 t	75 t
Foot width x depth (AxB)	1030 x 800 mm	1140 x 800 mm
Height (C)	1859 mm	1853 mm
Inside width (D)	730 mm	800 mm
Working range (E-F)	68,5 - 1048,5 mm	68 - 884 mm
Piston stroke	200 mm	250 mm
Piston move path (G)	240 mm	270 mm
Operating pressure	7.5 - 8.5 bar	7.5 - 8.5 bar
Weight	302,4 kg	451 kg

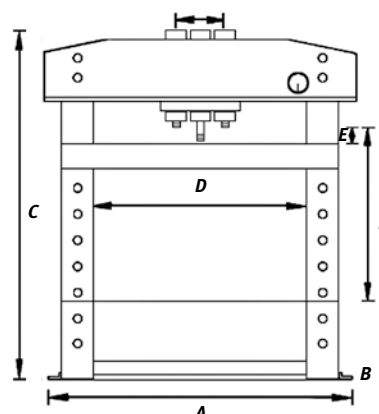

For more professional hydraulic workshop presses, see our **Metallkraft Catalogue** or visit [www.metallkraft.de](http://www.metallkraft.de)

## SSK Series - Sandblasting cabins for clean blasting work without soiling the work environment

- Suitable for a variety of blasting agents, e.g. quartz, glass peen shot, plastic peen shot, and more
- Ideal for cleaning, rust or paint removal from metal parts of all kinds, e.g., engine parts, fittings, signs, housings, rims, hinges
- Premium latex work gloves fastened on housing
- Cover with view window and adhesion-bonded protective film, equipped for the best possible view and protection while processing the workpiece
- Cover and door frame with circumferential seals for dust-free work
- With stable support grille for depositing

- workpieces on the inside of the cabinet
- With drain opening for changing the blasting agent
- Extraction hose for blasting agent fastened on bottom of catchment container
- With external compressed air coupling
- With rubber feet to prevent slipping and for stability

### Scope of delivery:

- Premium blasting gun with ceramic nozzle
- 4 pcs. ceramic nozzle (4 / 5 / 6 / 7 mm)
- 12 Volt neon tube with 230 Volt power supply and external switch
- Incl. 5 pcs. replacement film for view window
- Two large, integrated latex work gloves

### Scope of delivery SSK 3 where different:

- 2 neon tubes (230 Volt), in separate housing with protective pane and replaceable protective film, including 5 replacement films
- Light switch with dual function: extraction and cabin lighting are switched on and off at the same time
- Maximum working pressure controllable via pressure controller with pressure gauge



### SSK 1

- Cover easily lockable with rotary locks
- Cabin exhaust air opening equipped with dirt filter

### SSK 2

- Generously dimensioned door for loading and unloading
- Cabin exhaust air opening equipped with dirt filter
- 2 exhaust air openings (1 exhaust air connector Ø 92 mm and 1 exhaust air port Ø 64 mm) for connecting to an extraction unit

### SSK 3

- Two doors at sides and a front hood for fast and easy loading and unloading
- Integrated extraction unit with replaceable air filter
- Blasting gun without trigger - air flow controlled via foot pedal

Model	SSK 1	SSK 2	SSK 3
Article no.	620 4000	620 4001	620 4002
<b>Technical data</b>			
Cabin volume	90 l	220 l	340 l
Air consumption	200 - 350 l/min	200 - 500 l/min	400 - 800 l/min
Operating pressure	2.8 - 8.0 bar	2.8 - 8.0 bar	3.4 - 8.0 bar
Max. operating pressure	8.6 bar	8.6 bar	8.6 bar
Compressed air connection	3/8"	3/8"	3/8"
Blasting agent grain size	40 - 120 mesh	40 - 120 mesh	40 - 120 mesh
Interior cabin dimensions (mm)	580 x 480 x 300	840 x 550 x 360	1210 x 600 x 580
Exterior dimensions (mm)	590 x 485 x 490	950 x 660 x 1380	1310 x 920 x 1700
Weight	17 kg	55 kg	125 kg

Accessories for SSK 1	PU	Article no.
Gloves		620 4100
Sand blasting gun		620 4101
Filter		620 4102
Protective film	5	620 4103
View window		620 4104
Ceramic nozzle set 4/5/6/7mm		620 4130
Neon tube		620 4113

Accessories for SSK 2	PU	Article no.
Sand blasting gun		620 4101
Gloves		620 4110
Protective film	5	620 4111
View window		620 4112
Neon tube		620 4113
Ceramic nozzle set 4/5/6/7mm		620 4130

Accessories for SSK 3	PU	Article no.
Gloves		620 4120
Protective film	5	620 4121
View window		620 4122
Filter		620 4123
Ceramic nozzle set 2x6 mm/2x7 mm		620 4131
Sand blasting gun		620 4124
Protective window for lighting		620 4125
Protective film for lighting	5	620 4126



For matching compressors see the main AIRCRAFT catalogue, or visit [www.aircraft-kompressoren.com](http://www.aircraft-kompressoren.com)



## HKRS 1000 – Hydraulic body straightening set

- Hydraulic set in rugged plastic case with rollers
  - Packaged in small space
- portable, compact and practical

<b>Model</b>	<b>HKRS 1000</b>
Article no.	620 1200
<b>Technical data</b>	
Load lifting capacity	10 t
Tool width min	460 mm
Cylinder stroke	150 mm
Dimensions (LxWxH) (case)	1000 x 450 x 210 mm
Weight	31 kg

### Scope of delivery:

- Manual pump with hose
- Foot with rubber caps
- Adapter bolt with thread
- Extension tube set
- Corrugated support plate
- Pressure cylinder
- Spreader
- Rubber head
- 90° V support



## Vice 100/125/150/175 mm – rotatable with pipe clamping jaws

- Front-opening, premium wrought vice made of hardened break-proof steel
- Hardened, replaceable clamping jaws with grooved teeth
- Adjustable guide for parallel clamping
- With insertable and rotatable pipe clamping jaws, thus ideal, e.g., for plumbers
- Large, hardened, anvil surface for smaller straightening and ramming work
- Spindle guide in housing offers optimum protection against damage and soiling
- Foot rotates continuously through 360° with arresting option
- Painted in hammer effect blue



Model	Vice 100mm*	Vice 125mm*	Vice 150mm*	Vice 175mm*
Article no.	635 0100	635 0125	635 0150	635 0175
<b>Technical data</b>				
Jaw width in mm	100	125	150	175
Clamping width in mm	102	125	152	180
Clamping depth in mm	66	82	104	108
Anvil size in mm	73 x 58	78 x 73	90 x 84	104 x 99
Overall length in mm	305	355	455	530
Rotary plate in mm	128	145	165	190
Drill holes in rotary plate, Ø in mm	10.3	13.5	14	14

\* incl. rotary plate and pipe clamping jaws

## Anvils – made of alloyed cast steel, hardened with round and square horn

- with one round and one square horn
- with Hardie hole and Pritchel hole
- Ground and hardened face, extended through to square horn
- Made of alloyed cast steel



Model	Anvil 25kg	Anvil 50kg	Anvil 100kg
Article no.	635 1025	635 1050	635 1100
<b>Technical data</b>			
Anvil surface (without horns)	142 x 110 mm	175 x 130 mm	228 x 169 mm
Length of square horn	170 mm	200 mm	260 mm
Length of round horn	150 mm	199 mm	259 mm
Diameter of Pritchel hole	18 mm	18 mm	23 mm
Dimensions of Hardie hole	17 x 17 mm	20 x 20 mm	26 x 26 mm
Foot area	175 x 145 mm	210 x 165 mm	273 x 214 mm
Overall dimensions (LxWxH)	462 x 145 x 145 mm	574 x 165 x 150 mm	747 x 214 x 195 mm
Weight	25 kg	50 kg	100 kg

Interested in more products?



[www.holzkraft.de](http://www.holzkraft.de)



[www.optimum-maschinen.de](http://www.optimum-maschinen.de)



[www.aircraft-kompressoren.com](http://www.aircraft-kompressoren.com)



[www.schweisskraft.de](http://www.schweisskraft.de)



[www.metallkraft.de](http://www.metallkraft.de)



[www.holzstar.de](http://www.holzstar.de)

The publication of this catalogue renders all previous price lists invalid.

- Prices are recommended retail prices, subject to change, in €, plus statutory VAT, plus packaging, shipping, transportation, unloading, installation and training costs as applicable.
- We accept no liability for printing errors, mistakes or incorrect representation.
- Technical and visual changes reserved.
- Some illustrations show optional accessories

- Delivery is effected solely on the basis of our terms of delivery and payment
- All items are sold through specialist retailers.
- The goods shall remain our property until payment has been received in full.
- Our retention of title shall remain valid in case of sale to a third-party.
- Legal warranty conditions apply for businesses.
- Copying and reproduction in full or in part is subject to written approval by us.

#### Sales Germany:

UNICRAFT – Stürmer Maschinen GmbH  
Dr.-Robert-Pfleger-Straße 26  
D-96103 Hallstadt/Bamberg  
Phone: +49 (0) 951 - 96 555-0  
Fax: +49 (0) 951 - 96 555-55  
Email: [info@unicraft.de](mailto:info@unicraft.de)

#### Sales Austria:

AIRCRAFT Kompressorenbau GmbH  
Gewerbestraße Ost 6 · A-4921 Hohenzell  
Phone: +43 (0) 77 52 - 70 929-0  
Fax: +43 (0) 77 52 - 70 929-99  
Email: [info@aircraft.at](mailto:info@aircraft.at)  
[www.aircraft.at](http://www.aircraft.at)

Your specialist retailer:

[www.unicraft.de](http://www.unicraft.de)